

SPOCK

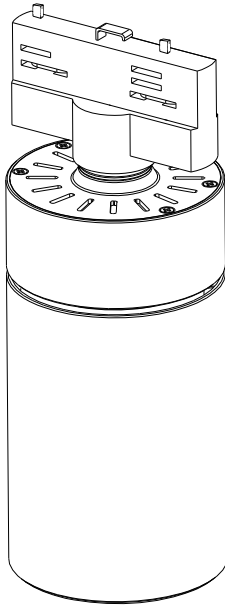

INSTRUCTION MANUAL

SERIES: SPOCK-TRACK SPOT MULTI-EYES/COB

Read these instructions completely and carefully.

⚠ ATTENTIONS

- Read the instruction carefully before installation , non-observation of this instruction may cause damage to the fixture or hurt to human body. The installation must be carried out by a qualified electrician in accordance with local or national codes.
- Cut off the power supply before installation and maintenance !
- Cut off the power supply before the electric wire connection for product first test.
- Regularly check the light source , the LED power supply, the cord and other accessories. If any part is damaged, the product should not be used.
- Keep this instruction manual handy for future use.
- The light source of these products are non-changeable light diodes(LED).
- Do not disassemble the product, as the light diode can cause damage to the eyes.
- Use only in indoor,dry location.Clean the product with a dry cloth.
- The luminaire shall be mounted out of arm's reach. The recommended installation height shall be at least 2,5 meter (above the ground)."

Lesen Sie diese Anweisungen vollständig und sorgfältig durch.

⚠ ACHTUNG

- Lesen Sie die Anweisungen sorgfältig vor der Installation durch. Bei Nichtbeachtung dieser Anweisung kann Schäden am Produkt oder Verletzungen am menschlichen Körper verursachen. Die Installation muss von einem qualifizierten Elektriker gemäß örtlichen oder nationalen Vorschriften durchgeführt werden.
- Schalten Sie die Stromversorgung vor der Installation und Wartung aus!
- Schalten Sie die Stromversorgung vor dem elektrischen Anschluss des Produkts für den ersten Test aus.
- Überprüfen Sie regelmäßig die Lichtquelle, das LED-Netzteil, das Kabel und andere Zubehörteile. Wenn ein Teil beschädigt ist, sollte das Produkt nicht verwendet werden.
- Bewahren Sie diese Bedienungsanleitung für zukünftige Verwendung auf.

Dimensions: (mm)

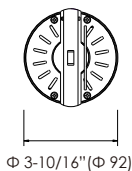
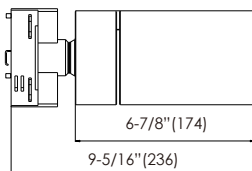

	Model	Rated input	Power	ta
EU	SPOCK-R1-220V	220~240VAC	11W	-4~95°F (-20 C ~35 C)
	SPOCK-R1-220V-1		15W	
	SPOCK-R1-220V-2		32W	
	SPOCK-R11-220V		10W	
	SPOCK-R11-220V-1		14W	
	SPOCK-R11-220V-2		28W	

US	SPOCK-R1-120V	100~120VAC	11W	-4~95°F (-20 C ~35 C)
	SPOCK-R1-120V-1		15W	
	SPOCK-R1-120V-2		32W	
	SPOCK-R11-120V		10W	
	SPOCK-R11-120V-1		14W	
	SPOCK-R11-120V-2		28W	

Tools



Electrical Safety Gloves



Clean cloth



Cleaning liquid (50% ethanol)



Sucker



1

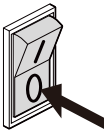

2

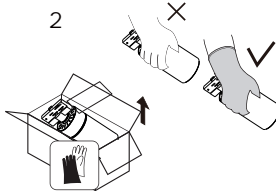

3

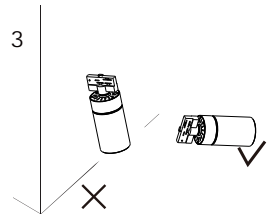

Installation(EU)

1

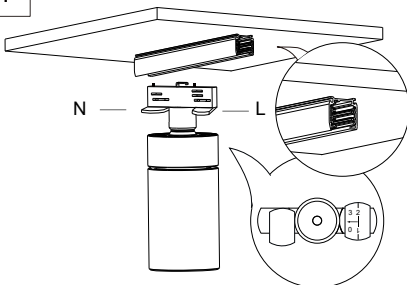

Track layout should be refer to the track installation manual. Turn "L" and "N" knob to perpendicular position to adapter before installing the fixture.

2

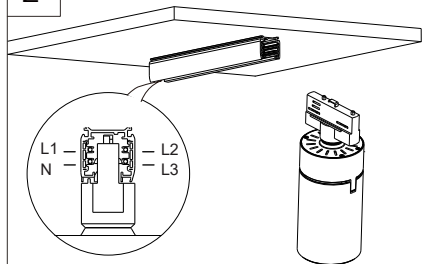

Insert the track light into the track groove. Keep the rib of the adapter with the same level of track surface.

3

Turn "N" knob 90° counterclockwise after inserting the track light.

4

"L" knob has three choices to turn according to different circuit.
 L1: turn the "L" knob 90° counterclockwise.
 L2: turn the "L" knob 90° clockwise.
 L3: put down the "L" knob and turn 90° clockwise.

5

Clean the surface

6 Luminaire angle adjustment.

1 2 360° 90°

i Feature 1:

The reflector can be replaced for Track spot COB series.
Replace reflector according to your desired beam angle.

1. Open the cover with a sucker.

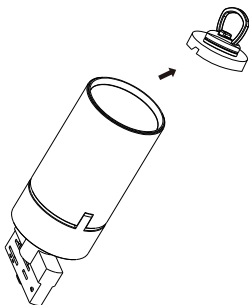

2. The reflector rotates out counterclockwise to replace a new one. Then install the cover.

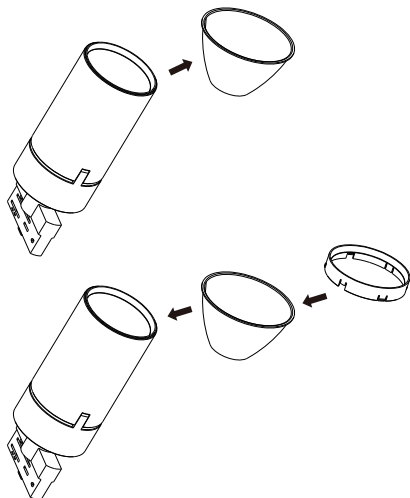

NOTE: The operation should be done only by a qualified electrician.

i Feature 2:

COB series light spot adjustable.

1. Open the cover with a sucker.

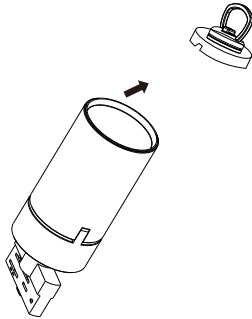

2. Set apart glass cover from the decorative ring.

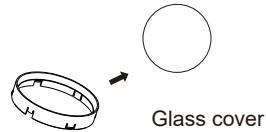

3. Put diffuser onto glass cover and insert into decorative ring.

Remark: matt side up.

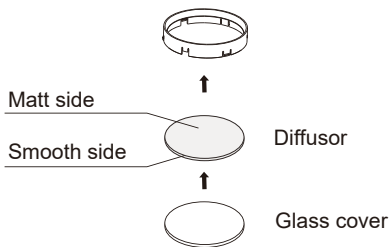

4. Install the cover into luminaire.

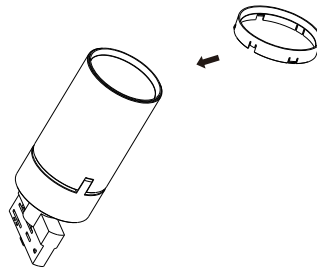

08/11/2023

Manufacturer

SELF ELECTRONICS CO., LTD.

Add: No. 1345 JuXian Road, Hi-Tech Park, Ningbo, China 315103

Importer

SELF ELECTRONICS GERMANY GMBH

Add: August-Horch-Str. 7, 51149 Cologne

(For European market)

SELF LIGHTING TECHNOLOGY PTY., LTD.

Add: 31/3 Homelea Court, Rivervale, WA, 6103, Australia

(For Oceanian market)

SELF ELECTRONICS USA CORP.

Add: 3264 Saturn Ct, Peachtree Corners, GA 30092

(For North American market)

SELF ELECTRONICS MIDDLE EAST DMCC

Add: Unit No. 1299, DMCC Business Centre Level No 1 Jewellery & Gemplex 3, Dubai, United Arab Emirates

(For Middle Eastern market)